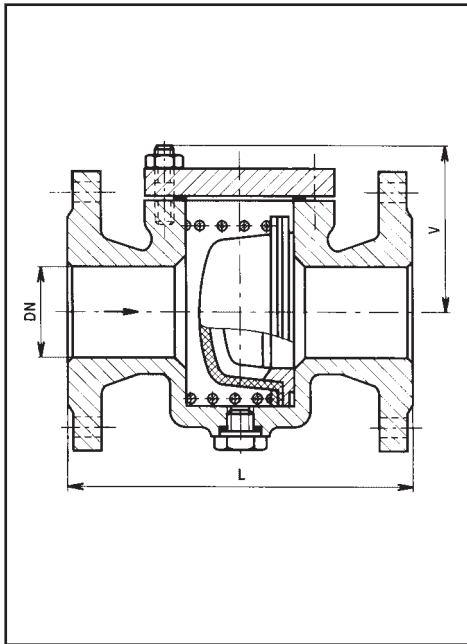

**DUST FILTER****USE**

The dust filter serves to a separation of solid particles from a gaseous working fluid. The filter is suitable for natural gas and all noncorrosive gaseous media. The maximum rate of the working fluid can be 15 m/s. A filter element is capable of trapping impurities with dimensions over 0,050 mm.

**TYPES / DN / PN / TEMPERATURE RANGES**

C26 604 516	DN 80, 100, 150, 200	PN 16	-10 to 80 °C
C26 604 540	DN 50	PN 40	-10 to 80 °C

**INSTALLATION**

The filter is mounted into a horizontal pipeline with a drain plug below. An entry of the working fluid is designated by an arrow. On a filter body there must not be transferred an additional stress from the pipeline. The filter does not need a continuous attendance but for securing a safe and efficient operation it is necessary to check a degree of a filter insert contamination (a pressure loss of the filter).

**CONNECTION**

Connecting flanges are carried out according to the DIN.

**MATERIAL**

	C26 604 516, 540	
	DIN	ČSN
Valve body	1.0619 N	42 2643
Valve cover	St 52-3	11 523
Filter fabric	PES	
Sealing	TEMACARB	

**DIMENSION TABLE**

DN	L	V	kg
C26 604 516			
80	230	120	21,0
100	230	120	24,0
150	250	165	46,0
200	270	190	65,0
C26 604 540			
50	210	95	16,3

**Note:** The dimensions of connecting flanges - see pages 43, 44.